

Mount Rainier Radio Control Society
Field and Flying Rules
November 2001, amended November 2005

Security

Member's keys fit the gate lock, the well house lock, and the two outside water hydrant locks.

The person opening the gate shall insert the lock in the bolt and close the lock. The last person to leave the field is responsible to ensure that all areas are secure.

Radios and Frequency Control

Only frequencies authorized by the Federal Communications Commission will be used for control of aircraft. All radios not in use are to be stored in the impound rack. No radio will be turned on unless the appropriate frequency pin is attached. If a club trainer box is used, the pin for the slave radio is not required. If other than a club trainer box is used, the pin for both the slave and master are required.

Newly installed radios and radios involved in a crash will be range checked before flight.

Safety

The Official AMA National Model Aircraft Safety Code shall govern all operations. A copy is posted in the sunshade and each AMA member receives a copy from AMA when the annual membership is renewed.

A fire extinguisher must be available when gasoline engines are operated.

Models will be hand carried or hand guided between the pits and the flight line, not taxied.

All persons not involved in model operations must remain behind the fence line or in the sunshade. Spectators desiring to visit the pit area may do so on request and if accompanied by a club member. Only pilots, instructors, callers, or spotters are allowed on the flight line; no more than two persons per pilot station.

Pets must be restrained or otherwise kept north of the fence line.

Flight Operations

Only four aircraft may be airborne at the same time. Pilots will use the marked pilot boxes. All flying will be conducted on the open field side of the yellow safety line (the near edge of the asphalt runway) and within club property boundaries. Sketch attached (or on reverse). Use of the grass strip and grass over runs is permitted at anytime, but pilots must remain in the marked pilot boxes unless no other aircraft are in flight.

Pilots will announce take off, touch and go, and landing operations. If necessary to cross the runway or retrieve a model from the runway, other pilots will be informed prior to doing so.

With prior notification to, and agreement from other flyers, hand launching may be accomplished from any position on the open field side (south) of the yellow safety line and in any direction other than towards the yellow safety line. All other flight operation rules apply.

General

Extended engine operation for break in or extended tuning will be accomplished in the vicinity of the green and brown sheds. Internal combustion engines will not be operated before 8 A.M. Acceptable engine noise is 96 dB, or less, at 9 feet at full throttle.

No open fires except in the marked area near the green shed. A connected water hose must be at the ready.

Approved November 20, 2001, changed November 19, 2005.

**FLY WITHIN THE
PROPERTY BOUNDARIES
DO NOT FLY OVER THE
TREES TO THE SOUTH
OR POWER LINES TO
THE WEST**

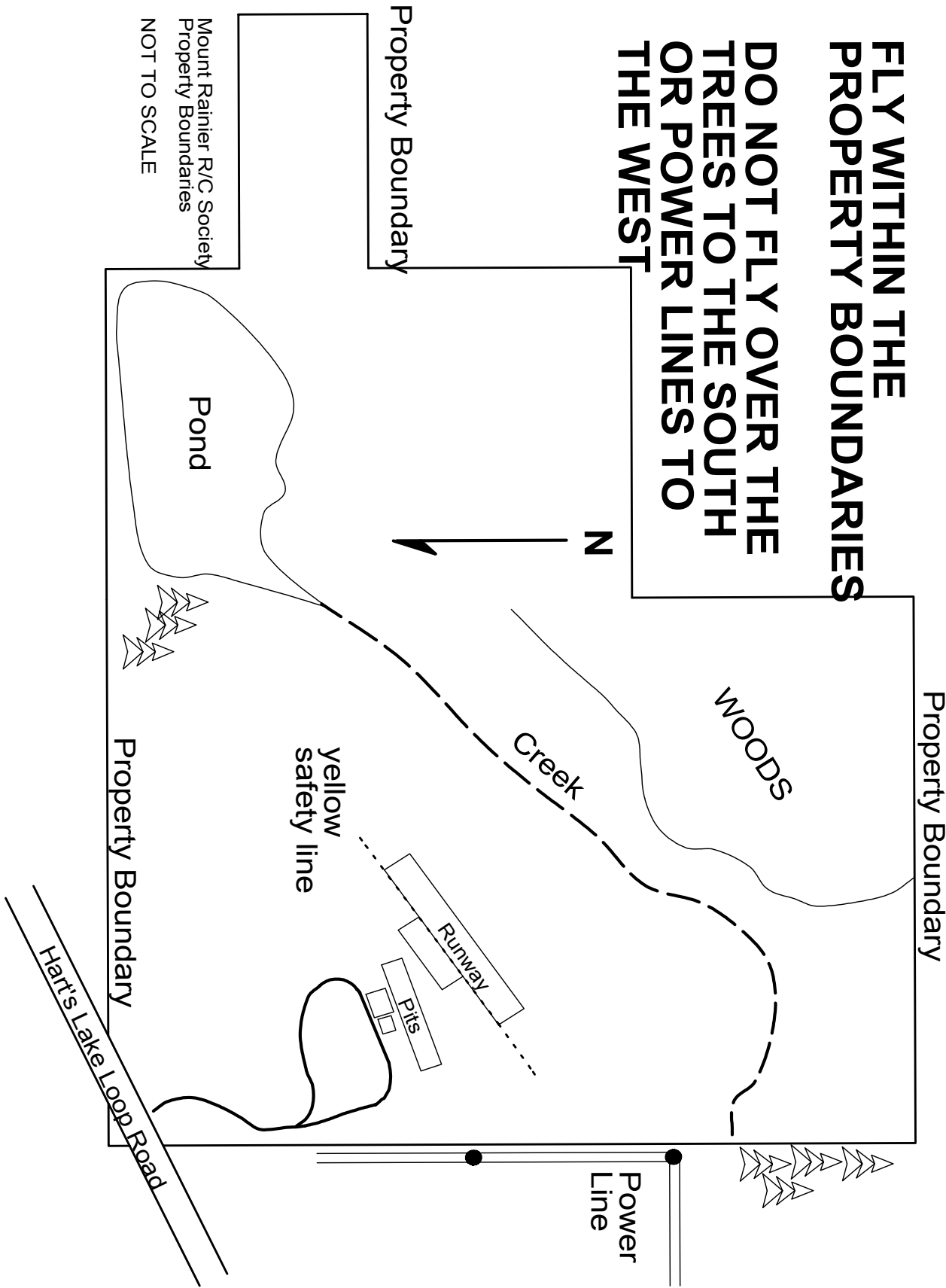

Mount Rainier R/C Society
Property Boundaries
NOT TO SCALE